

Step 3: Mounting the Wall Plate: Wood Stud, Brick, Solid Concrete, and Concrete Block mounting options are provided.

Warning: DO NOT OVERTIGHTEN THE LAG BOLTS! Tighten Lag Bolts (u) only until the Lag Bolt Washer (v) is pulled firmly against the Wall Plate (a)

Wood Stud mounting:

The Wall Plate (a) **must be mounted to two wood studs at least 12" apart.** Use a high quality stud sensor to locate two adjacent studs. It is a good idea to verify where the studs are located with an awl or thin nail shown in Diagram 3a. Pre-drill a 2.5" deep hole at the desired height in each stud using a 3/16" drill bit. Make sure these holes are in the center area of the studs and level with each other. Use the Wall Plate as a template to mark the location of the second hole in each stud. Drill 2.5" deep holes using the 3/16" drill bit in the marked locations. Attach the Wall Plate to the wall using the four 1/4 x 2.5" Lag Bolts (u) and four Lag Bolt Washers (v). Make sure the Wall Plate is oriented so the flat surface in the center of the plate is against the wall and that a set of Lag Bolts is on each side of the two large holes in the center as shown in Diagram 3b.

Brick, Solid Concrete and Concrete Block mounting:

Use the Wall Plate (a) as a template to mark 6 hole locations on the wall. The outer holes must fall to left and right of the two large holes in the middle of the plate. Three in the top row of slots and three more in the bottom row. Make sure these holes are level and there is at least 6" between any two holes. Pre-Drill these holes with a 1/2" masonry bit to at least 2.5" in depth. Insert a Concrete Anchor (w) into each of these holes. Make sure the anchor is seated completely flush with the concrete surface **even if there is a layer of drywall or other material in front.** Attach the Wall Plate to the wall using 6 Lag Bolts (u) and 6 Lag Bolt Washers (v).

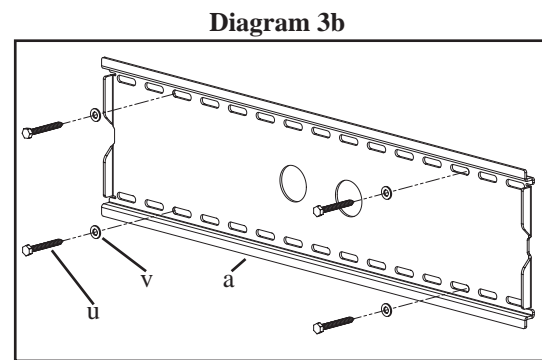
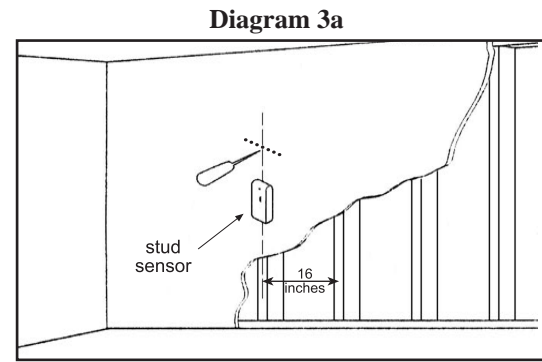

Step 4: Choose mounting position:

You can mount your television in either of two positions: flat or at a 5 degree downward tilt. To mount the television flat to the wall use only the Monitor Brackets (c). To mount the television in the 5 degree tilt position you must first add two Gussets (d) to each Monitor Bracket with two Carriage Bolts (x) and two Gusset Nuts (y) as shown in Diagram 4.

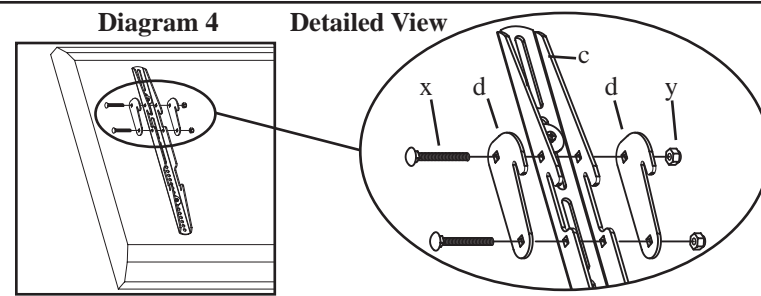

Step 5: Hang the TV onto the Wall Plate:

First hook the Monitor Brackets (c) over the top of the Wall Plate (a), then let the bottom of the Monitor Brackets rotate in under the bottom of the Wall Plate. This process is shown with the flat mount option in Diagram 5a, and with the 5 degree tilt option in Diagram 5b. Once the TV is in place, insert the Safety Bar (b) into the slots in the bottom of the Monitor Brackets so that it sits behind the bottom tab on the Wall Plate as shown in Diagram 5c. The bend at the end of the Safety Bar should face toward the wall. Once the bar passes out the other side of the Wall Plate a padlock can be added to the hole in the Safety Bar for additional security.

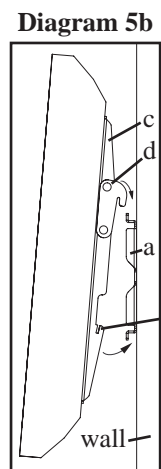
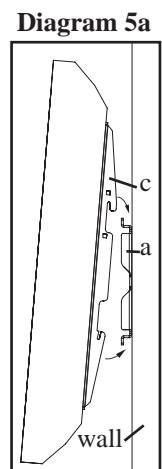

slot for safety bar

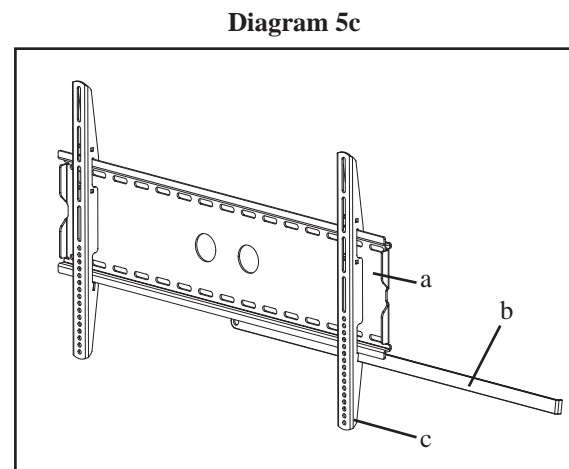

SANUS SYSTEMS

THE UNION OF FORM AND FUNCTION

Assembly Instructions for VMPL2 Flat Panel Wall Mount

Thank you for choosing a Sanus Systems Vision Mount Wall Mount. This product is designed to mount flat panel televisions weighing up to 175 lb. to a vertical wall. It allows you to mount your television flat against the wall or at a fixed 5 degree tilt.

Safety Warning: If you do not understand these directions, or have any doubts about the safety of the installation, please call a qualified contractor or contact Sanus at 800.359.5520 or www.sanus.com. We can quickly assist you with installation questions and missing or damaged parts. Replacement parts for Sanus products purchased through authorized dealers will be shipped directly to you. Check carefully to make sure there are no missing or defective parts. Never use defective parts. Improper installation may cause damage or serious injury. Do not use this product for any purpose that is not explicitly specified by Sanus Systems. Sanus Systems can not be liable for damage or injury caused by incorrect mounting, incorrect assembly, or incorrect use.

Note: The supplied wall mounting hardware is not for steel stud walls or old cinder block walls. If you are uncertain about the nature of your wall, consult an installation contractor. Sanus makes every effort to assure all necessary television mounting hardware is included. If the hardware you need is not included please consult your local hardware store or call Sanus Systems.

Required Tools: 3/16" drill bit, 1/2" Masonry Bit for brick concrete or concrete block installations, wrench or socket set, Phillips screw driver.

Supplied Parts:

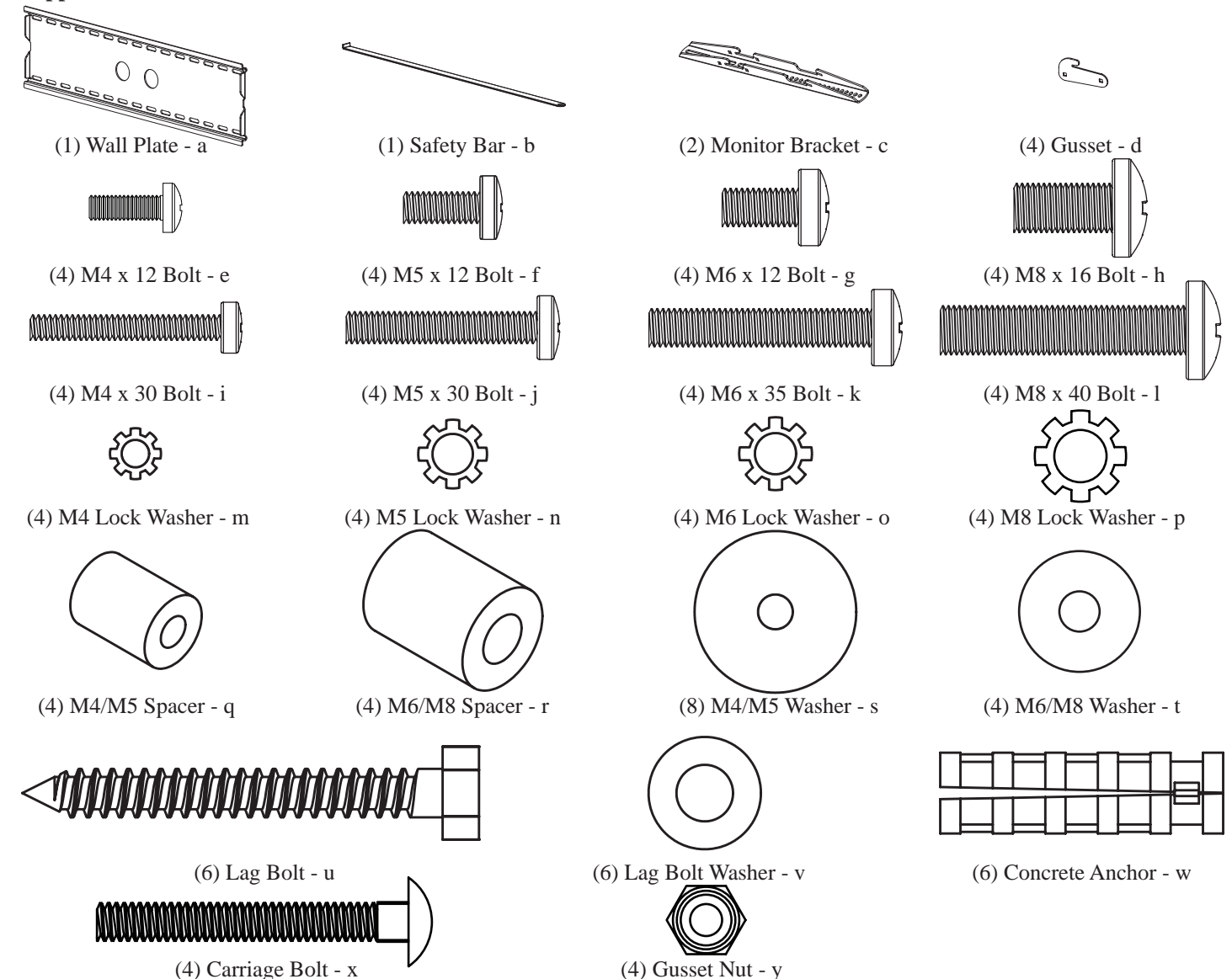

Step 1: Mounting Monitor Brackets to a television with a flat back

First, determine the diameter of the Bolt (e,f,g,h) your TV requires by hand threading them into the threaded insert on the back of the TV. If you encounter any resistance stop immediately! Once you have determined the correct diameter, see the appropriate Diagram below. You will thread the Bolt through the appropriate Lock Washer (m,n,o,p), a Washer (s,t), the Monitor Bracket (c), and finally into the TV. Make sure the Monitor Brackets are vertically centered and level with each other.

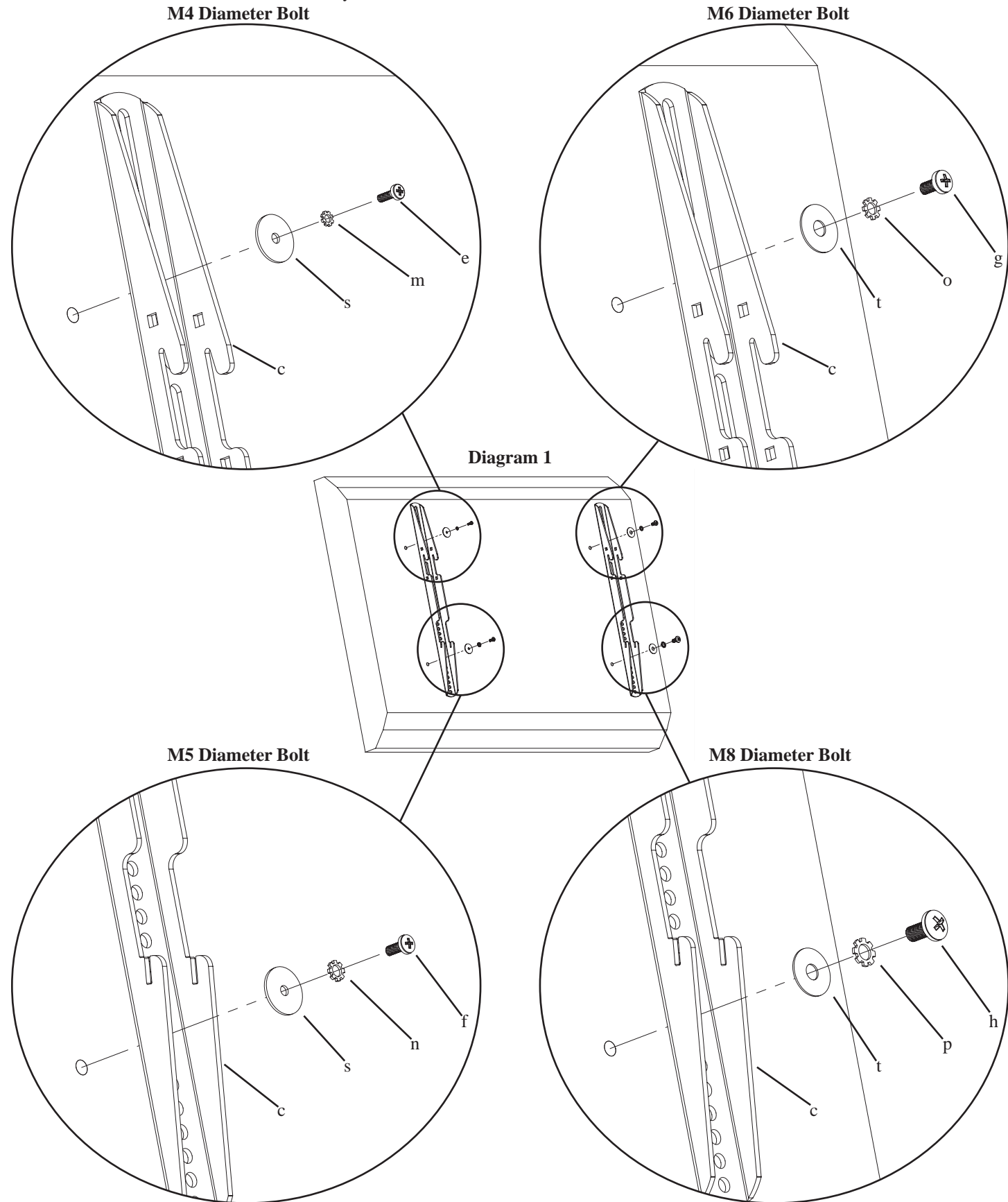

Step 2: Mounting the Monitor Brackets to a television with a curved back, recessed threaded inserts or any other obstruction.

First, determine the diameter of the Bolt (i,j,k,l) your TV requires by hand threading them into the threaded insert on the back of the TV. If you encounter any resistance, stop immediately! Once you have determined the correct diameter, see the appropriate Diagram below. You will thread the Bolt through the appropriate Lock Washer (m,n,o,p), a Washer (s,t), the Monitor Bracket (c), a spacer (q,r) and finally into the TV. For the M4 or M5 diameter bolt, you will need another M4/M5 Washer between the Monitor Bracket and the Spacer. Make sure the Monitor Brackets are vertically centered on the TV and level with each other.

