

# Instruction Manual

HITACHI Refrigerator

For household use only

## No Frost

### Model

**R-B500PT6**



# HITACHI

Inspire the Next

Contents	Page
Warning and Caution for Safety	2
Preparations before Use	4
Location of food storage	4
How to use Control Panel	5
Other Function	
-Door Alarm and ECO Alarm Function	5
-Quick Freezing	6
-Child Lock	6
-Energy Saving	6
Freezer Compartment	6
-Twist Ice maker	6
Refrigerator Compartment	7
-Selectable Mode Compartment	7
-How to install and remove parts	7
Maintenance	
-Cleaning	8
-Troubleshooting	8
-Service Center	9

**R600a**  
Refrigerant

Thank you very much for purchasing of HITACHI refrigerator.  
Before using the refrigerator, please read the instruction manual carefully for the correct usage.

Maintenance work must only be carried out at workshop by well-trained maintenance worker.

# Warning and Caution for Safety

To avoid harm to the user, other persons or damage to property, please read and follow the warnings and cautions below and those given throughout this manual.

The following warnings and cautions are categorized by the level of possible harm or damage that may occur from ignoring directions.

	<b>Warning</b>	This pictograph indicates "There is a high possibility of serious injury or death, if ignored".
	<b>Caution</b>	This pictograph indicates "There is a high possibility of injury or damage to property, if ignored".

The symbols are shown as below clearly showing the significance of directions.

The symbols below are examples.	
	This symbol is an alert mark.
	This symbol indicates "prohibited".
	This symbol indicates "necessary".

- This refrigerator uses flammable refrigerants. The symbol column below states the precautions on flammable refrigerants.

R600a

This symbol denotes the precautions on flammable refrigerants.

## Warning

### When you install ... To avoid fire, electric shock, and injury.

- Do not install the refrigerator in a place where it may come in contact with water.
- Do not install the refrigerator in a place exposed to rain.
- This may impair electricity insulation and cause electric shock or fire.



- Ground this refrigerator to prevent electric shock and noise interference. Always ground this refrigerator and install earth leakage circuit breaker. Fix with earth screws when using it in places with high humidity or moisture. (Please consult with a retailer or HITACHI service center.)



### Power Cord and Power Plug ... To avoid fire, electric shock.

- Do not connect the wall outlet whose power capacity is less than the refrigerator's. Also, do not use power sources that are not a rated voltage.
- If a power source is shared with other appliances using double or multipoint adapters, the adapter may heat up beyond the normal level and cause fire.
- Do not use a damaged or loose power plug or power outlet. This may cause fire or electric shock.
- Do not cut, bend, fold the power cord to avoid fire and electric shock.
- Do not insert or remove the power plug with wet hands.



- Connect the power plug firmly to a power outlet with the cord running down.
- Connection of the power plug with the cord running up could apply stress on the cord and cause electrical short or overheat, which could result in electrical shock or fire.
- Incomplete connection of the power plug could result in electrical shock or fire due to heat.
- If the supply cord is damaged, it must be replaced by the manufacturer, its service agent or similarly qualified persons in order to avoid a hazard.
- Clean the dust on the power plug frequently with dry cloth.
- Unplug the power plug and wipe it with dry cloth.
- An insulation failure due to moisture or when dust collects on the power plug may cause fire.
- Be sure to unplug the power plug before maintaining the refrigerator.
- Be sure to hold the power plug to unplug.

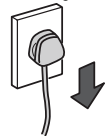

### During daily use ... To avoid fire, electric shock.

- Do not splash water on or inside the refrigerator.
- This may impair electricity insulation causing electric shock or fire.
- This may also cause gas leakage because of pipe rust.
- This appliance is not intended for use by persons (including children) with reduced physical, sensory or mental capabilities, or lack of experience and knowledge, unless they have been given supervision or instruction concerning use of the appliance by a person responsible for their safety.
- Do not hang on the doors or step up on the various compartments.
- Injury may be caused by the refrigerator tipping over or hands getting caught in door.
- Do not enter in the refrigerator.
- Do not damage the refrigerant circuit.
- If you happen to damage the refrigerant pipe, stay away from the refrigerator and avoid using fire and electrical appliances.
- And, open windows to ventilate and contact retailers or HITACHI service center.



- Do not disassemble, repair, or modify the refrigerator by yourselves.
- Please consult with a retailer or HITACHI service centre if any repair is required.
- Ether, liquid propane gas, solvent, etc. which is volatile cannot be stored in this refrigerator.
- Do not store explosive substances such as aerosol cans with a flammable propellant in this appliance.
- Do not put water containers or foreign articles on the top of the refrigerator.
- Opening and closing doors etc. may cause the articles on the top of the refrigerator to fall down, resulting in injury.
- Medicines, chemicals, research and experimental substances should not be stored in the refrigerator.
- Substances that require precise conditions for storage cannot be stored in a domestic refrigerator.



## Warning and Caution for Safety (Continuation)

### Warning

- Do not use electrical appliances inside the food storage compartments of the appliance, unless



- In an event of a flammable gas leak, do not touch the refrigerator and open windows for ventilation.
  - Sparks from points of electrical contacts such as door switches may ignite explosions causing fire or a burn.

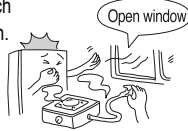

- Do not make an impact on the glass-made doors or shelves.
  - They are made of tempered glass, however, an excess impact may be result in breakage and is dangerous.



- Do not use mechanical devices or other means to accelerate the defrosting process, other than those recommended by the manufacturer.



- Children should be supervised to ensure that they do not play with the appliance.
  - Children getting inside may not be able to get out.



- Keep ventilation openings in the appliance enclosure or in the built-in structure clear of obstruction.

- If you find something wrong with the refrigerator, immediately unplug and consult with the retailers or HITACHI service centre.

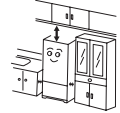

#### When discarding the refrigerator.

- Follow the instructions of your region when discarding.
  - This refrigerator uses R-600a for the refrigerant and cyclopentane for the blowing agent of the urethane heat insulation.

- When discarding the refrigerator, remove the door gaskets.
  - To avoid a risk of an infant or child to be entrapped inside.



### Caution

#### During daily use ...To avoid illness and injury.

- Do not put bottles, etc. forcibly in the door pockets.
  - This may cause bottles to drop down or door pockets to come off.



- Do not store food which smells or food whose color is changed abnormal.
  - Such an action may cause diseases.



- Food and containers inside the freezer compartment should not be touched with wet hands.
  - This may cause frost injury. (Especially in case of metal items.)



- Do not hold the top, bottom and side of the doors when closing them.
  - This may result in your fingers being caught by the door edge.

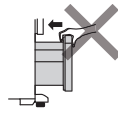

- If someone else is using the refrigerator, do not open the door.
  - Fingers may get caught in the spaces between the doors and may cause injury.



- Do not have food items protruding over the front edge of each shelf.
  - Doors may not be closed properly or the door pockets may drop down. Injury may be caused from items like bottles getting knocked over your feet.



- Do not store glass bottles in the freezer compartment.
  - Bottles may break by the contents freezing and cause injury.

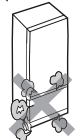

- Do not put your hands into the base surface of the refrigerator cabinet.
  - When cleaning, putting your hands near the base surface of the refrigerator may result in injury by thin metal sheets.



- Be sure to hold the handle firmly to open or close the door.

- Do not have your feet too close when opening the door of the refrigerator.
  - When opening the door, your feet may be hit, resulting in injury.

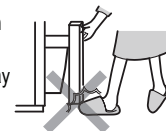

#### When moving or carrying ...To avoid damaging, wetting, soiling the floor, or to avoid injury.

- Do not use door handles when carrying the refrigerator.
  - Never use the carrying handles to hang up with a chain hoist or similar machines.

- Use the carrying handle when carrying the refrigerator.
  - Hold the carrying handles only. If hold door handles, hands may slip and may cause injury.
  - Carry the refrigerator by at least 4 persons for safety reasons.
  - Carry it with the doors facing upward.
  - Before carrying the refrigerator:
    - Take out all food items and ice cubes.
    - Lay a protective sheet or cloth to protect the floor from damage and catch remaining water spilled from the refrigerator.
    - With a large piece of old cloth underneath, tilt the refrigerator backward to drain water.
    - Finally carry the refrigerator with the doors facing upward.
  - Secure the doors well with adhesive tapes so they do not open.
  - If transporting in a vehicle, do not load the refrigerator on its side. This could damage the compressor.

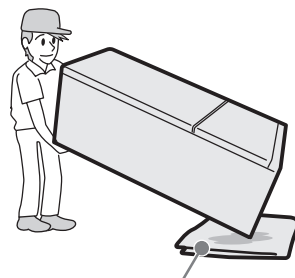

Such as old cloth

- On a floor that is easily scratched, do not move the refrigerator with the wheels of refrigerator.
  - The wheels may scratch the floor.
  - For a floor that may be easily scratched, lay a protective mat, etc. .

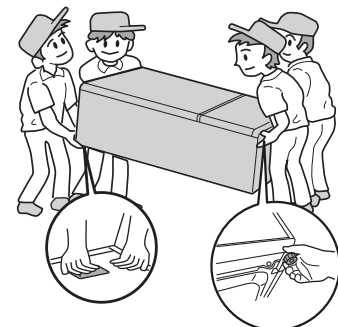

#### When replacing lamps (LED) is required.

- When lamps (LED) need to be replaced, please contact Hitachi Service Center.

## Preparations before Use

### Installation

1. Install on a rigid and level floor.
  2. Please use this refrigerator between the room temperature of 10°C to 43°C.  
Sufficient performance may not be obtained, if the room temperature is too low or too high.
  3. Do not install where the refrigerator is exposed to direct sunlight or other heat sources.
  4. Install in an atmosphere which is dry or has air ventilation.
  5. The refrigerator requires enough air ventilation space around the cabinet to have efficient cooling performance.  
Space of at least 5 cm over the top, 5 cm at rear and 5 cm at both sides for proper air circulation is needed.
  6. Ground the refrigerator to prevent electric shock and noise interference. Always ground this refrigerator when using it in places with high humidity or moisture. (Please consult with retailers or HITACHI service centre.)
  7. Adjusting the adjustable legs to keep the left/right refrigerator door level.
    - Without adjusting the legs, door height may not be level, or there may be abnormal vibration or noises depending on floor conditions. Follow the instructions below.
- (1) Turn the adjustable legs until they touch the floor firmly.

### Caution

Back & both sides of fridge is hot proceed from hot gas pipe inside.

Rear side more than 5 cm

More than 5 cm

More than 5 cm

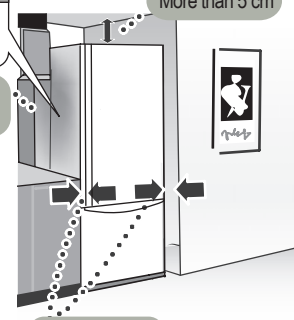

Adjustable Leg

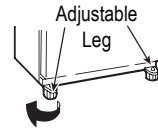

### Beginning

1. Cleaning inside the refrigerator. Wipe the surface gently with soft cloth.
2. Connect the refrigerator to an exclusive wall power outlet.  
The refrigerator can be connected to an outlet soon after it is installed.  
Surely use with the rated voltage and exclusive power outlet.
3. The compressor will start running in approximately 30 seconds, if inside is not cold.
4. Allow enough duration for sufficient cooling before storing food.  
It may take about 4 hours to fully cool down and could even take about 24 hours when the ambient temperature is high.

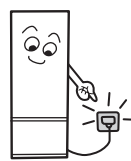
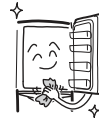

4 hrs.

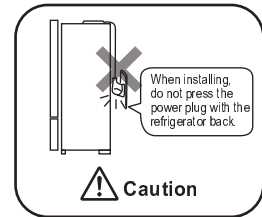

### Food storage

1. Keep enough space between food. Several food placed too close together may obstruct the flow of cold air.
2. Make food cool enough before putting it in the refrigerator.  
Putting warm food in the refrigerator raises the inside temperature and wastes electricity.
3. Do not block the cold air vent. This will adversely affect the cold air flow and may not keep the temperature inside even. Moreover, it could result in food near the vent freezing.
4. Using food wrap or sealed containers prevent the food from drying or transition of smells.

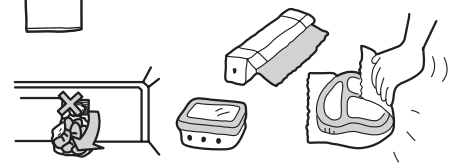
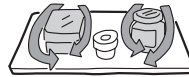

## Location of Food Storage

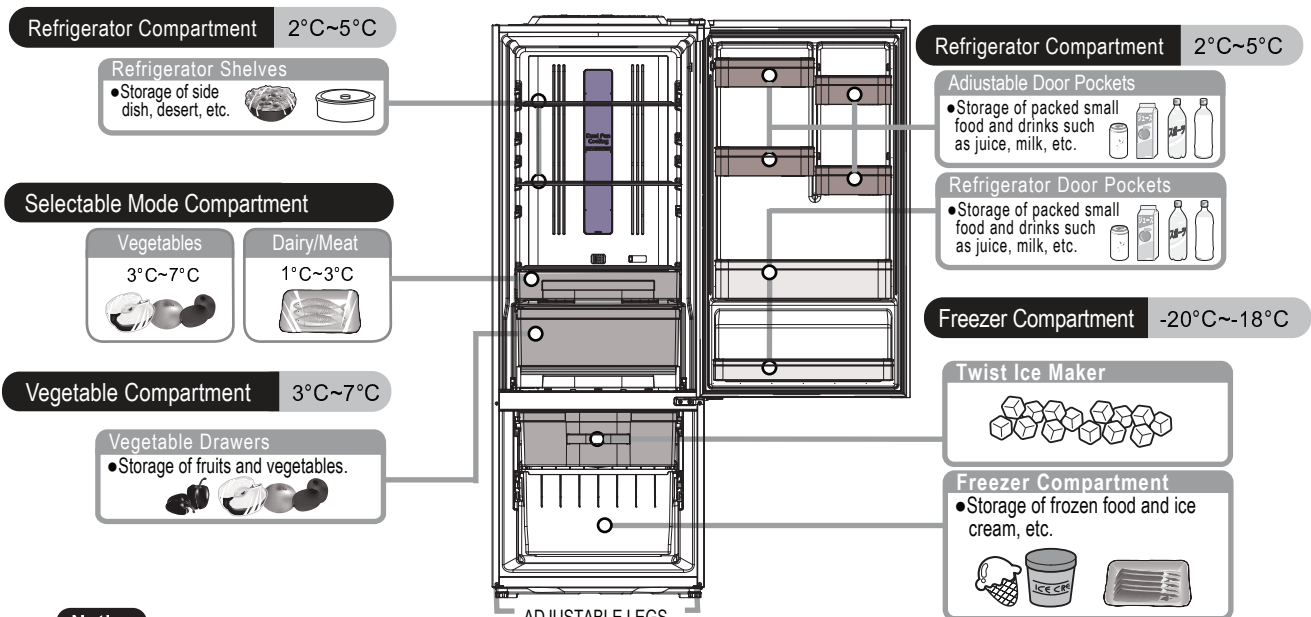

### Notice

- Above temperatures are the approximate values in the conditions of outside temperature 32°C, the temperature setting of the refrigerator compartment "3°C", freezer compartment "-19°C", doors being closed and without food storage.
- Door pocket temperatures may be slightly higher than above temperatures.
- The specification of your purchased model may be different from one of the above illustration.

# How to use Control Panel

## □ Name and Functions of Display

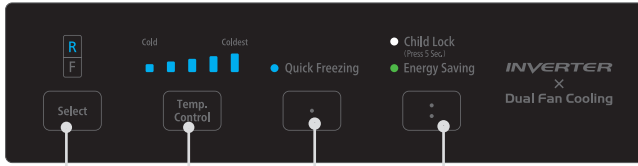

Compartment Selection  
 F: Freezer compartment  
 R: Refrigerator Compartment

Temp setting  
 Quick Freezing  
 Child Lock / Energy Saving

### Notice

- If you unplug the power plug or a power failure occurs and then the refrigerator restarts, the temperature display and each setting will be automatically resumed \*\*\*. However, "Quick Freezing" operation will be cancelled.
- Approximately 30 seconds after the end of operation, all LED become unlit.
- Response of the touch panel may change depending on the surrounding temperature, humidity, physical condition of the user or operation status of the adjoining electric product.
- The panel may not respond if it is wet or dirty.

## □ Temperature control

### ■ Freezer Compartment

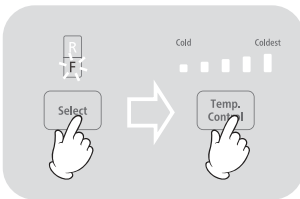

Touch "Select" button "F" lamp light is on.  
 Touch "Temp. Control" button to setting a temperature.

<p>When storing neighter frozen food nor ice cream.</p> <p><b>Cold</b> ( Sound " Pi " )</p>	<p>For normal use.</p> <p><b>Normal</b> ( Sound " Pi Pi " )</p>	<p>When making ice quickly or making frozen food quickly. Or, a surrounding temperature is high and the Freezer compartment is not cold enough.</p> <p><b>Coldest</b> ( Sound " Pi " )</p>
---	---	--

The display is indicating the status of temperature setting.

### ■ Refrigerator Compartment

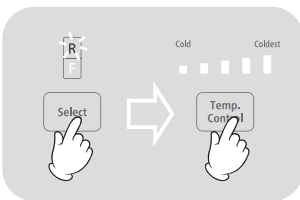

Touch "Select" button "R" lamp light is on.  
 Touch "Temp. Control" button to setting a temperature

<p>When the food is too cold</p> <p><b>Cold</b> ( Sound " Pi " )</p>	<p>For normal use.</p> <p><b>Normal</b> ( Sound " Pi Pi " )</p>	<p>When cooling food more coldly or quickly</p> <p><b>Coldest</b> ( Sound " Pi " )</p>
--	---	--

The display is indicating the status of temperature setting.

\*\*\* There must setting more than 45 seconds before unplug the power or power failure. otherwise the temperature display shown as before setted.

## Other Function

### Door Alarm and ECO Alarm Function (Only Refrigerator compartment)

If the door is left open for more than 1 minute, the alarm system will inform the user by the sound and digital display.

- Door Alarm: Informs by PeepPeepPeep sound.
- Eco Alarm Display: Indicates the door opening state on the control panel.

Duration of Door Opening	Door Alarm Sound	ECO Alarm Display
After 1 minute	PeepPeepPeep	All LED on display - are Flashing
After 2 minute	PeepPeepPeepPeepPeep	
After 3 minute	Peeps continuously.	

#### To Disactivate Alarm and Sound

1. Keep touching "Quick Freezing" for 5 seconds until "Peep!" sound is heard.



There is not sound when touching any button (deactive door alarm sound).



#### Notice

- Upon shipment, the alarm and sound are set "ON".
- If the Door Alarm, Eco Alarm Display and each button operation sound have been deactivated, the refrigerator will still set the alarm and sound to "OFF" even though a power failure or when unplugging and reconnecting the power plug.

#### To re-activate Alarm and Sound

1. Keep touching "Quick Freezing" for 5 seconds until "PiPi!" sound is heard.

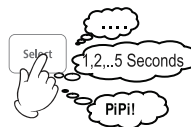

There is sound when touching any button (active door alarm sound).



(There must setting more than 45 seconds before unplug the power or power failure. otherwise the temperature display shown as before setted.)

## Other Function (Continuation)

### Quick Freezing

When you want to freeze food or make ice quickly, use this function.

Touch "Quick Freezing" for Start Quick Freezing operation, lamp light is on.



Touch "Quick Freezing" again for stop Quick Freezing operation, lamp light is off.



After 2 hours (approx.) Quick freezing operation will be finished, lamp light is off.

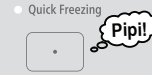

2 Hours (Approx.)

**Notice** • During "Quick Freezing", priority cooling of the freezer compartment will be done. Thus, try to avoid unnecessary opening and closing the doors not to have a temperature rise of the refrigerator compartment.

### Child Lock

You can prevent mischief of all the buttons on the control panel caused by children.

1

Touch "Child Lock" for 5 seconds ("Child Lock" light is on).

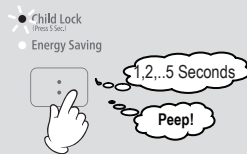

2

To stop this function, touch "Child Lock" for 5 seconds again ("Child Lock" light is off)

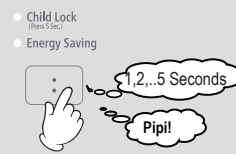

### Energy Saving

Recommend to use this function in case of low storage volume, or a long vacation when the doors are not opened for long time.

1

Touch "Energy Saving" for Start Energy Saving operation, light is on.



2

Touch "Energy Saving" again for stop Energy Saving operation, light is off.

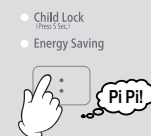

**Notice** • In case the compartment temperature rises up, the operation will be back to a normal setting temporarily.  
• After a long time operation of "Energy Saving", in some cases, fatty ice cream, etc, may become soft. Please stop "Energy Saving" operation in this case.  
• If you Touch "Quick Freezing" button during "Energy Saving" operation, "Energy Saving" operation will be done after "Quick Freezing" operation finished.

## Freezer Compartment

### Twist Ice Maker

Put the "Twist Ice Maker" in the upper freezer drawer on the right.

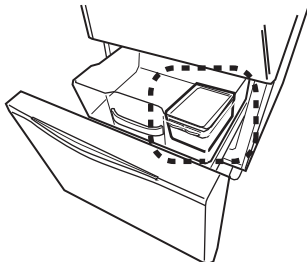

- When you wish to make ice more quickly.
  - Use the "Quick Freezing" operation.
  - Remove "Ice Cover".

### How to use the Ice Maker

1. Take the "Twist Ice Maker" and pour in water up to the full line.
2. After ice is made, turn the lever firmly by following arrow and drop the ice into the "Ice Bank".

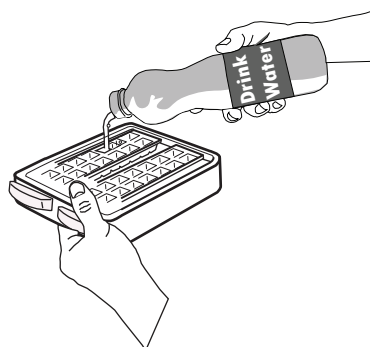

### Notice

- The ice making time will be longer in the following situations:
  - When using the "Twist Ice Maker" for the first time (There are cases where 24 hours or longer is required).
  - When the door is frequently opened and closed
  - When a large amount of food is placed inside the refrigerator at the same time
  - When there is a power outage
  - During winter or when the surrounding temperature is low
  - After the ice tray has been serviced

# Refrigerator Compartment

- If you keep the refrigerator in a hot and humid place, frequently open the door or store a lot of vegetables, it may cause dew forming which has no effect on its performance. Wipe the dew with dry cloth.

## Selectable mode compartment

Vegetable • ————— • Dairy/Meat

Set the lever to "Vegetable" to provide temperature for vegetable and fruit 3°C~7°C

Set the lever to "Dairy / Meat" for dairy / meat 1°C~3°C

- There is a temperature control which can adjust the amount of cold air flowing into the drawer.

### Caution

- If you want to store meat or fish longer, please store them in the freezer compartment.
- Be careful, it might be frozen if that food has a lot of moisture.
- When closing the refrigerator door, also close the chiller case. If you close the door while the chiller case is still pulled out, chiller case might be broken.
- Meat and fish can be kept fresh before being frozen.

## How to install and remove parts

### Door Pocket

- Gently tap the left and right of the bottom surface while pulling a pocket up to remove it. When installing the pockets, push it all the way down in a smooth, controlled manner.

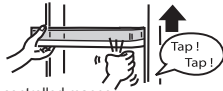

### Freezer Compartment

Pull out the Freezer compartment door, and lift up the upper freezer case and lower freezer case as shown.

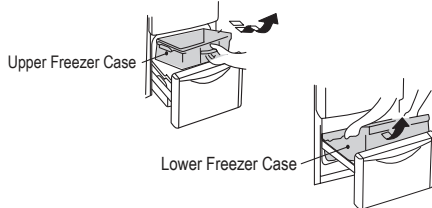

### Vegetable Compartment

- To remove Vegetable Case, pull out the Vegetable Slide Tray, then lift the Vegetable Case upward. (Follow as arrow 1 and 2)
- To remove Vegetable Slide Tray, after removing the Vegetable Case, lift the front of the tray up slightly. (Follow as arrow 3)

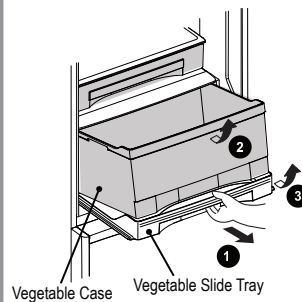

### Selectable Mode Compartment

- To remove Selectable Mode Compartment, pull it all the way out, then lift it upward.

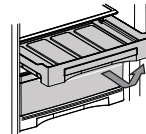

### Adjustable-height Shelves/Fixed Shelf

- To remove a shelf, lift it up slightly, then pull it towards you. To install a shelf, push it in until it comes into contact with the end of the slot.

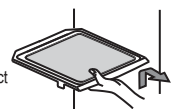

### Adjustable-height Shelves

- The height of these shelves can be adjusted to match the height of your food.
1. Remove all food stored on the shelf.
  2. Lift the front of the shelf upward slightly, then pull the shelf out towards you.
  3. Adjust the shelf to the desired height, then push the shelf in until it reaches the back of the slot.



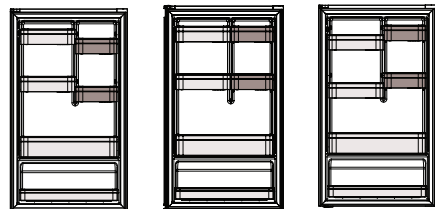

### Adjustable-height Door Pocket

- The height of these pockets can be adjusted to match the height of your food.

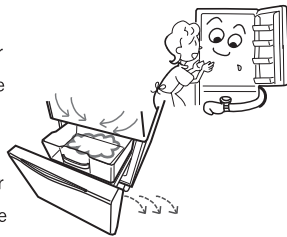
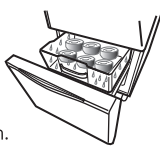
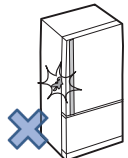
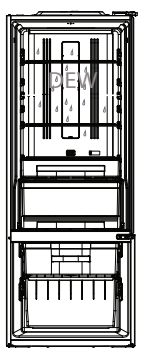

# Dew or Frost is generated

	General operation	Please check here	Possible causes and /or Recommended solutions
Dew or Frost is generated in the freezer compartment		The door of the freezer compartment was not left open temporarily?	Check that the wrapping paper of the food is not getting caught in order not to make gap between door and door gasket when you close the door.
		The door of the freezer compartment was not opened frequently or longer time than necessary?	When the door is opened frequently or if the door is opened when the humidity around the refrigerator is high, moisture in the air may be turned into some frost or ice on the inner wall or component of the freezer compartment, or around the air channels. This is not a failure. Please try not to open the door too many times or for a long time. Also, please wipe frost or ice generated in the freezer compartment off with use of a dry cloth. 
		Making extra ice by using an additional ice-tray which was not originally installed in the refrigerator?	When the many containers in which water or liquid is stored are put in the same time, water or liquid may be evaporated and turned into frost or ice on the wall or component of the freezer compartment, or around the air channels. You can suppress these frost and ice by putting lid to avoid evaporation. Please wipe frost and ice off with use of a dry cloth. 
Dew is generated in the refrigerator compartment		The door of the refrigerator compartment was not left open temporarily?	Please check not to pinch the food or plastic bag between the door and door frame when you close the door. 
		The door of the refrigerator compartment was not opened frequently or longer time than necessary?	When the door is opened frequently or if the door is opened when the humidity around the refrigerator is high, moisture in the air may be turned into some dew on the inner wall or component of the refrigerator compartment, or around the chilled air blow-off port. This is not a failure. Please try not to open the door too many times or for a long time. Also, please wipe off the dew in the refrigerator compartment with a dry cloth. 
		Storing many vegetables containing much water?	The humidity of the vegetable compartment is higher than other compartments. Accordingly, depending on the amount or type of the vegetable, dew condensation may be generated on the plastic case of vegetable compartment. However, this is not a failure. When you do not want to have this kind of dew, please wrap your vegetables in a plastic film. Also, when the dew condensation happens many times, water may be accumulated in the vegetable compartment. Please wipe the water off with a dry cloth.
Dew is generated on the outer surface of the refrigerator		The volume of humidity around the refrigerator is not high?	When the humidity rises such as in rainy day, some dew may be generated on the outer surface of the refrigerator. Please wipe the dew off with a dry cloth.
		The temperature setting is not set as "Coldest"?	When the temperature setting is set as "Coldest", some dew may be generated on the outer surface of the refrigerator. Please set the setting as "Normal". Also, please wipe dew off with use of a dry cloth. 

## Why frost and dew are generated?

When warm and humid air contacts something cold, dew is generated. For example, if you put some ice in the glass in your room, air around the glass will be cold down and some dew may be generated on the outer surface of the glass.



In the same way, when warm and humid air enters into the refrigerator at the door opening, the warm and humid air contacts cold inner wall and little dew may be generated.

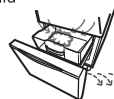

Accordingly, if the door opening is too frequent or too long, dew will be accumulated at every door opening. In some cases, dew may be frozen to generate some frost or ice flakes in the freezer compartment.



# Cleaning

## ■ Cleaning (To Clean the refrigerator once a month)

1. Unplug the refrigerator.
2. Take out all the food.
3. Wipe the refrigerator clean.
  - It is highly recommended to wiping off smudges immediately. It is also recommended to clean the areas of the refrigerator which are not easily accessible, once a year.
  - Use soft cloth with lukewarm water to wipe off smudges. If it is difficult to remove smudges, use diluted, ph-balanced washing liquid.
  - Neatly clean the door gasket, because it gets dirty easily.
4. If any droplets remain on the surface of the parts, wipe them off.
5. Return all parts to their original locations.
6. Check and clean the power plug, cord and outlet.
7. Plug the power cord into the outlet.

### Notice

- Even if the power plug is plugged in immediately after being unplugged, the compressor will not run for 10 minutes. However, if the inside is not cold, it will start running in approximately 30 seconds.

### Caution

- Do not do the following, since parts and paint may be damaged.
1. Do not splash water to the doors and refrigerator body.
    - It may cause electric shock or a fire.
    - It may cause refrigerant leakage because of pipe rust.

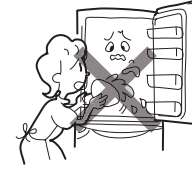

2. Do not use following: Polishing powder, soap powder, oil, boiling water, brush, acid, benzene, thinner, alcohol and alkaline detergent, etc.
  - It may damage door surface.
  - It may crack plastic parts.
3. If the cooking oil smears on the refrigerator, please wipe it off immediately. Otherwise, the plastic parts might be cracked.

# Troubleshooting

Before you call for service, please check the following items:

The refrigerator does not get cold at all.	<ul style="list-style-type: none"> <li>● Is the refrigerator plugged in properly?</li> </ul>	<ul style="list-style-type: none"> <li>● Check the fuse box for blown fuse or tripped circuit breaker.</li> </ul>
The refrigerator does not get cold enough.	<ul style="list-style-type: none"> <li>● Is the refrigerator placed in the direct sunlight?</li> <li>● Is the temperature set to "Cold"?</li> <li>● Is the food stored too much?</li> <li>● Is the door being slightly opened ?</li> </ul>	<ul style="list-style-type: none"> <li>● Is the refrigerator placed near heat sources?</li> <li>● Has anything hot been placed in the refrigerator?</li> <li>● Is the door being opened and closed too frequently?</li> </ul>
Food in the refrigerator compartment freezes.	<ul style="list-style-type: none"> <li>● Is the temperature set to "Coldest"?</li> <li>● Do you place food with moisture or vegetables nearby the cold air vent? It will be frozen if it is placed nearby the cold air vent.</li> </ul>	
Dew appears.	Outside	<ul style="list-style-type: none"> <li>● When the ambient humidity is too high, the door gasket may have dew. Please wipe it up with dry cloth.</li> </ul>
	Inside	<p>Please wipe it off with dry cloth and please check the details below.</p> <ul style="list-style-type: none"> <li>● Is the door closed firmly?</li> <li>● Is it too humid outside?</li> <li>● Is the door being opened and closed too frequently or opened for a long time?</li> </ul>
The inside is smelling.	<ul style="list-style-type: none"> <li>● Do you store food with odor without wrapping it?</li> </ul>	
The refrigerator is noisy.	<ul style="list-style-type: none"> <li>● Make sure the refrigerator is installed firmly.</li> </ul>	<ul style="list-style-type: none"> <li>● Is the refrigerator touching the wall?</li> </ul>

The Control Panel does not respond:

The Control Panel does not respond:	<ul style="list-style-type: none"> <li>● Is "Child Lock" selected by using the lock function on the panel for operation?</li> <li>● Is Refrigerator the compartment Door open? Operate after closing it.</li> <li>● Are you wearing gloves or applying a plaster? Touch directly with your finger.</li> </ul>	<ul style="list-style-type: none"> <li>● Is there water or dirt on the Control Panel?</li> <li>● Are you touching a next button? Touch only one button at a time</li> </ul>
The Control Panel is unlit.	<ul style="list-style-type: none"> <li>● Approximately 30 seconds after the end of operation, Indicator LED become unlit.</li> </ul>	

This is not a malfunction of the refrigerator.

The surface of the refrigerator is hot.	<ul style="list-style-type: none"> <li>● The refrigerator is equipped with the dew prevention and heat radiation tubes. The back and side plates may be heated especially when starting up or if the door is frequently opened and closed.</li> </ul>
If a door is shut, other doors may open.	<ul style="list-style-type: none"> <li>● The two compartments are connected with an air duct. When closing one of the doors, the door may be opened by the air pressure through the duct. This is a normal phenomenon.</li> </ul>
Does the refrigerator make any abnormal noises (sound)?	<ul style="list-style-type: none"> <li>● The sound like water flowing and boiling water is the sound of the cooling liquid (refrigerant).</li> <li>● A creaking sound comes from the storage compartment. It is the sound caused by friction of the parts due to temperature change.</li> </ul>
There are waving and/or distortions on the door surface, the side and the top surface of the refrigerator.	<ul style="list-style-type: none"> <li>● Slight waving and/or distortions are generated in the manufacturing process of the refrigerator. They may be conspicuous according to the position of the light source and/or the brightness etc., but there is no problem with the performance.</li> </ul>

## Service Center

- Before you request repair, please check the refrigerator well according to page number 9. If it is still abnormal, please contact the retailer of purchase or the following service center.

### Service Center

Hitachi Australia Pty Ltd.  
Locked Bag 2052, North Ryde NSW 1670  
Email: [custserv@hitachi.com.au](mailto:custserv@hitachi.com.au)  
Phone no.: 1800 HITACHI  
1800 4482244  
Web: [www.hitachi.com.au](http://www.hitachi.com.au)  
Monday to Friday business hours 9am – 5pm (AEST)

- Telephone number is subject to change without notice.

#### About Non-fluorocarbon refrigerator.

- This refrigerator, including refrigerant and the heat insulator, is using hydrocarbon (non-fluorocarbon). The hydrocarbon is a material that does not rip up the ozone and have very little influence on global warming. It is the global environment concern material).
- R600a refrigerant is flammable. But the refrigerant is sealed up by the refrigerant circuit, and never leaks by usual use. In case of the refrigerant circuit being damaged by any chance, please avoid using fire or electric product, open the window and ventilate. Afterwards, please contact Hitachi Service Center.

#### Severe warning signs for Disposal

Cyclopentane is used as in the insulation. The gases in insulation material require a special disposal procedure.  
Please contact your local authorities in regard to the environmentally safe disposal of this product.



This symbol mark means that used electrical and electronic products shall not be mixed with general household waste. Do not try to dismantle the system and unit by yourself as this could have harmful effects on your health and the environment. Refrigerators must be treated at a specialized treatment facility for recycling and recovery and shall not be disposed of in the municipal waste stream. Please contact the installer, dealer or local authority for more information.

### Warning

- Children should be supervised to ensure that they do not play with the appliance or get in.
  - Children getting inside may not be able to get out.
- This appliance can be used by children aged from 8 years and above and persons with reduced physical, sensory or mental capabilities or lack of experience and knowledge if they have been given supervision or instruction concerning use of the appliance in a safe way and understand the hazards involved.
- Children shall not play with the appliance.
- Cleaning and user maintenance shall not be made by children without supervision.

A large, empty rectangular box with rounded corners, intended for writing a memo. The box is white with a thin black border and occupies most of the page below the header.

**HITACHI**  
Inspire the Next